

## FST-2M-024

### Fiber Optic Modular Tray | Splice & PLC Splitter Compatible

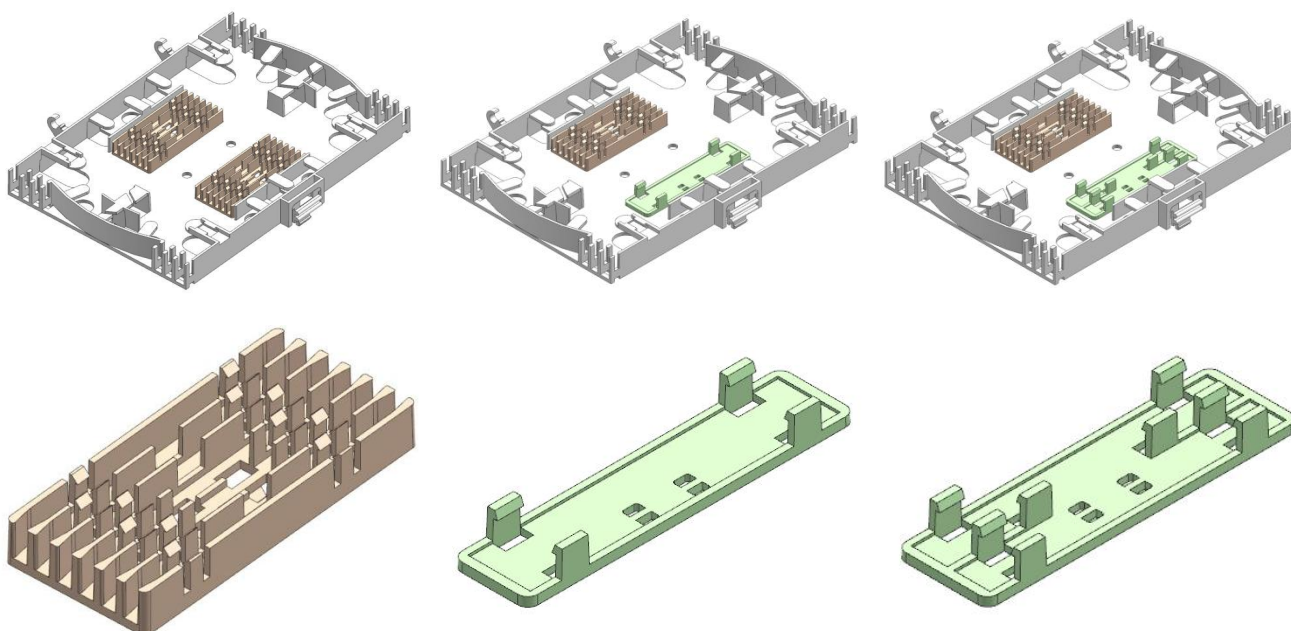

Splice modules  
(for up to 12F Single fusion)

Splitter modules  
(for **One** 1:16 Micro PLC)

Splitter modules  
(for up to **Two** 1:8 Micro PLC)

### Application

- For use with FDB-24Z Fiber Distribution Box.
- For use with FAT-C12Y Series Hardened Terminal Box.

### Features & Benefits

The FST-2M-024 is an advanced, fully modular fiber management tray designed for ultimate deployment flexibility. Featuring a dual-bay architecture, it allows for the seamless integration of splicing and splitting functions within a single, high-performance platform, making it the premier choice for evolving FTTH and PON infrastructures.

- **Dual-Slot Modular Versatility:** Equipped with two independent, interchangeable slots that can be configured with any combination of splice modules or Micro PLC splitter modules (1:4, 1:8, or 1:16).
- **On-Site Network Customization:** Supports rapid, tool-less reconfiguration on-site, allowing service providers to transition from pure fiber distribution to active splitting without replacing the tray base or disturbing existing cable routing.
- **Optimized Fiber Integrity:** Engineered with precision-molded routing paths that guarantee a

minimum bend radius of 30mm, ensuring superior signal performance and long-term reliability for delicate fibers.

- **Hinged Accessibility & Stacking:** Utilizing a robust pivot-linked design, multiple trays can be stacked and flipped independently like a book, providing unobstructed access to any module for simplified maintenance and testing.

## Specifications

Part No.	FST-2M-024
Access Type	Hinged
Module Slots	2 Independent Slots (Supports Splice or Splitter modules)
Splice Capacity	6 / 12 Fibers per modules (Max 2 module, 24 FO per tray)
Splicing Method	Single Fusion
Splitter Capacity	Up to 2 modules
Splitter Compatibility	<b>One</b> 1:16 Micro PLC Splitter per Module <b>Two</b> 1:8 Micro PLC Splitter per Module
Dimensions (H × W × H)	153 × 123.3 × 22.6 mm
Fiber Bend Radius	≥30mm
Material	ABS or PC+ABS
Sleeve Compatibility	40 - 45 mm
Tray Cover	Plastic (Top) / Transparent (Intermediate)

## Ordering Information

Part No.	Description
FST-2M-024-12F	Fully loaded with 2 Splice modules for up to 24 fusion splices.
FST-2M-024-1P08	Fully loaded with 1 Splice unit and 1 Splitter unit for up to <b>two</b> 1:8 Micro PLC.
FST-2M-024-1P16	Fully loaded with 1 Splice unit and 1 Splitter unit for <b>one</b> 1:16 Micro PLC.

- ◆ Other configurations are available upon request. Customization supported.